



## FOR LEASE

4250 Keith Bridge Rd Cumming, GA. 30041

### Property Highlights:

- Suite 100 - 1750 +/- Square Feet - End Unit
- Available Now: 6/1/2026
- Monthly Rental Rate: \$1,895.00 base + CAM
- 1 large office with HVAC
- 1 bathroom
- Mostly warehouse
- Rear Drive in Door
- Vantage Pointe - Industrial Park
- Zoning: Highway Business
- North Forsyth Location/near exit 18 GA 400
- Landlord does not permit automotive or wood working uses
- Showings by appointment only



Presented by: Doug Sills, Associate Broker

 [Doug@BagleyCommercial.com](mailto:Doug@BagleyCommercial.com)

 770.781.5935 (office)

 [678-923-5538 \(Cell\)](tel:678-923-5538)

 [BagleyCommercial.com](http://BagleyCommercial.com)

*\*All information believed accurate but not warranted. Tenant responsible for verification.*

[www.BagleyCommercial.com](http://www.BagleyCommercial.com)



Presented by: Doug Sills  
Associate Broker

770.781.5935 (office) 678-923-5538 (cell)

Doug@BagleyCommercial.com

## 4250 Keith Bridge Rd Suite 100 Cumming 30041

\*Photos are of suite 120, more photos coming soon.\*



*\*All information believed accurate but not warranted. Tenant responsible for verification.*



Presented by: Doug Sills  
Associate Broker

770.781.5935 (office) 678-923-5538 (cell)

Doug@BagleyCommercial.com

## 4250 Keith Bridge Rd Suite 100 Cumming 30041

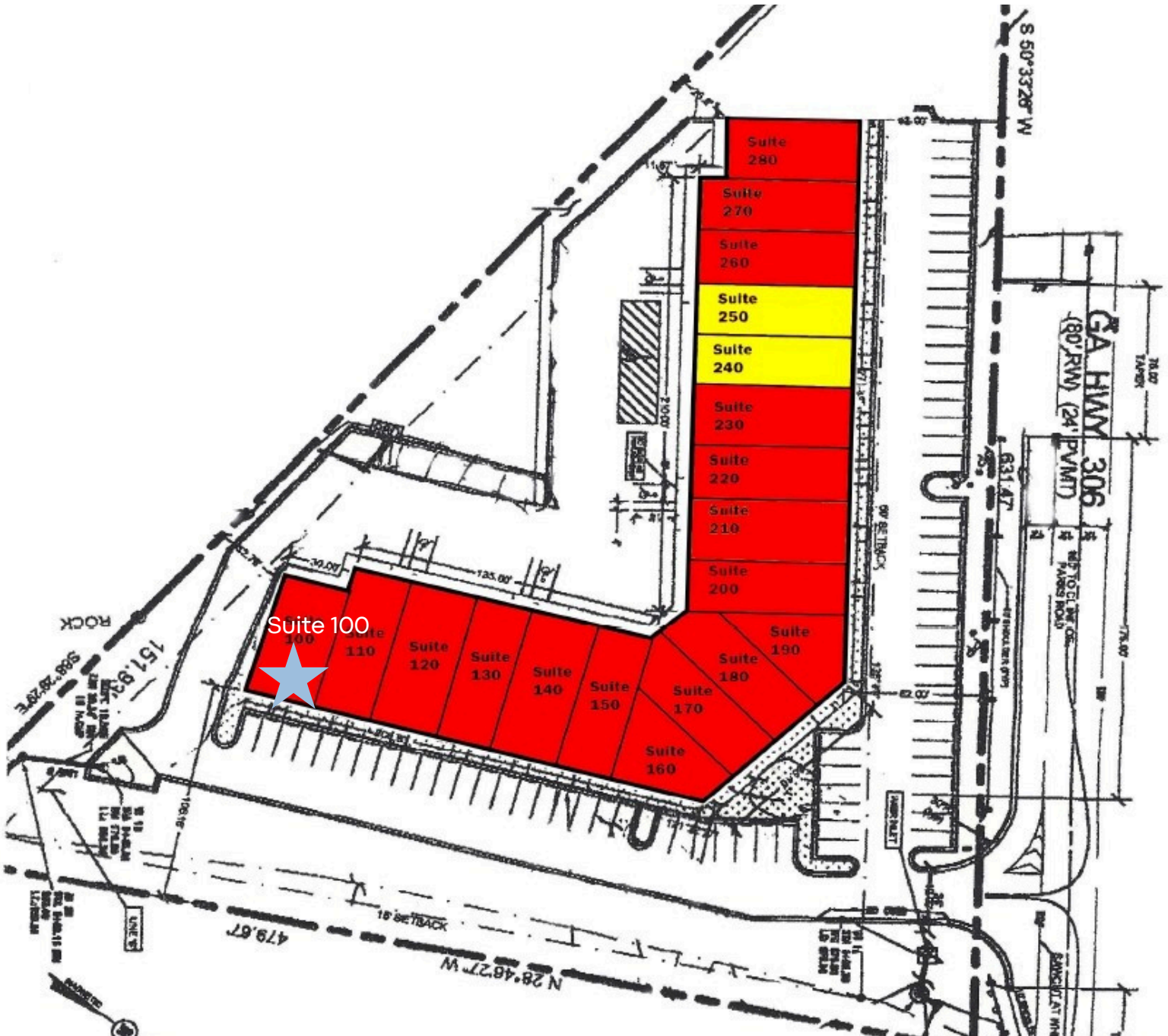

\*All information believed accurate but not warranted. Tenant responsible for verification.



# FLOORPLAN - Unit 100

4250 Keith Bridge Rd Cumming, GA. 30041

Presented by: Doug Sills  
Associate Broker

770.781.5935 (office) 678-923-5538 (cell)

Doug@BagleyCommercial.com

1750 +- Square Feet

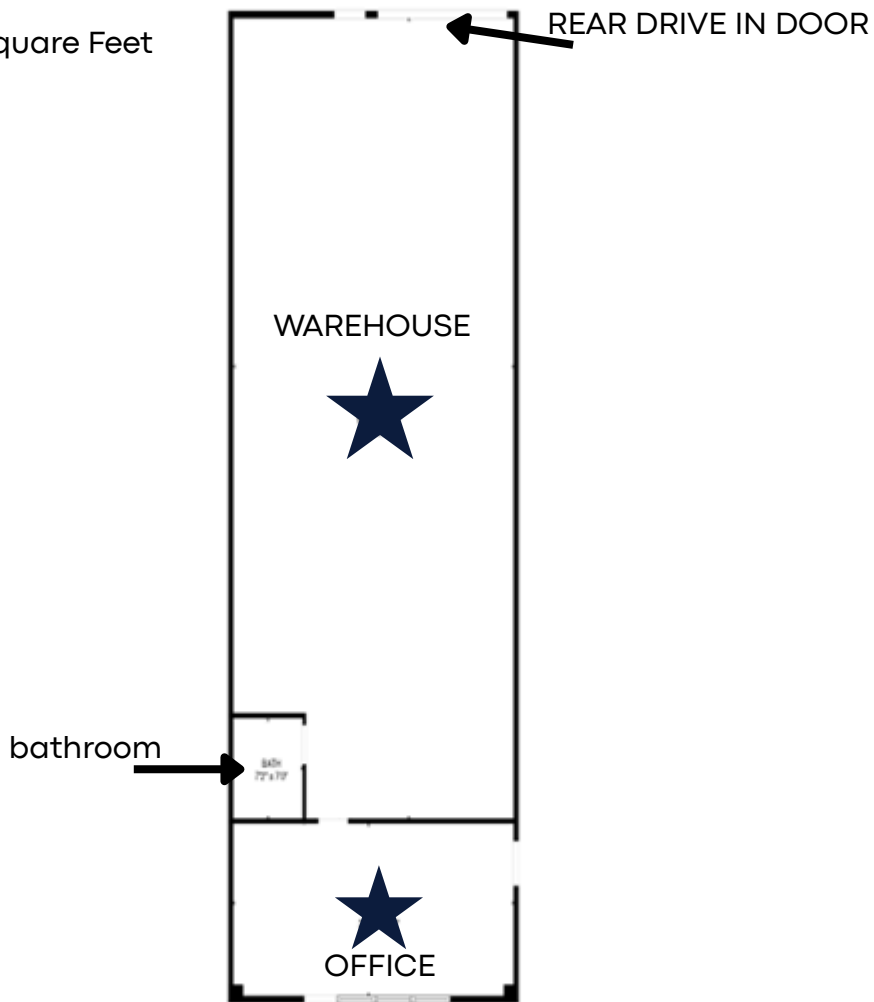

FLOOR PLAN CREATED BY CUBICASA APP. MEASUREMENTS DEEMED HIGHLY RELIABLE BUT NOT GUARANTEED.

**\*ALL MEASUREMENTS ARE APPROXIMATE.\***

*\*All information believed accurate but not warranted. Tenant responsible for verification.*



## LOCATION MAP

[4250 Keith Bridge Rd Unit 100 Cumming, GA. 30041](#)

Presented by: **Doug Sills**  
Associate Broker

 770.781.5935 (office)  678-923-5538 (cell)  
 [Doug@BagleyCommercial.com](mailto:Doug@BagleyCommercial.com)

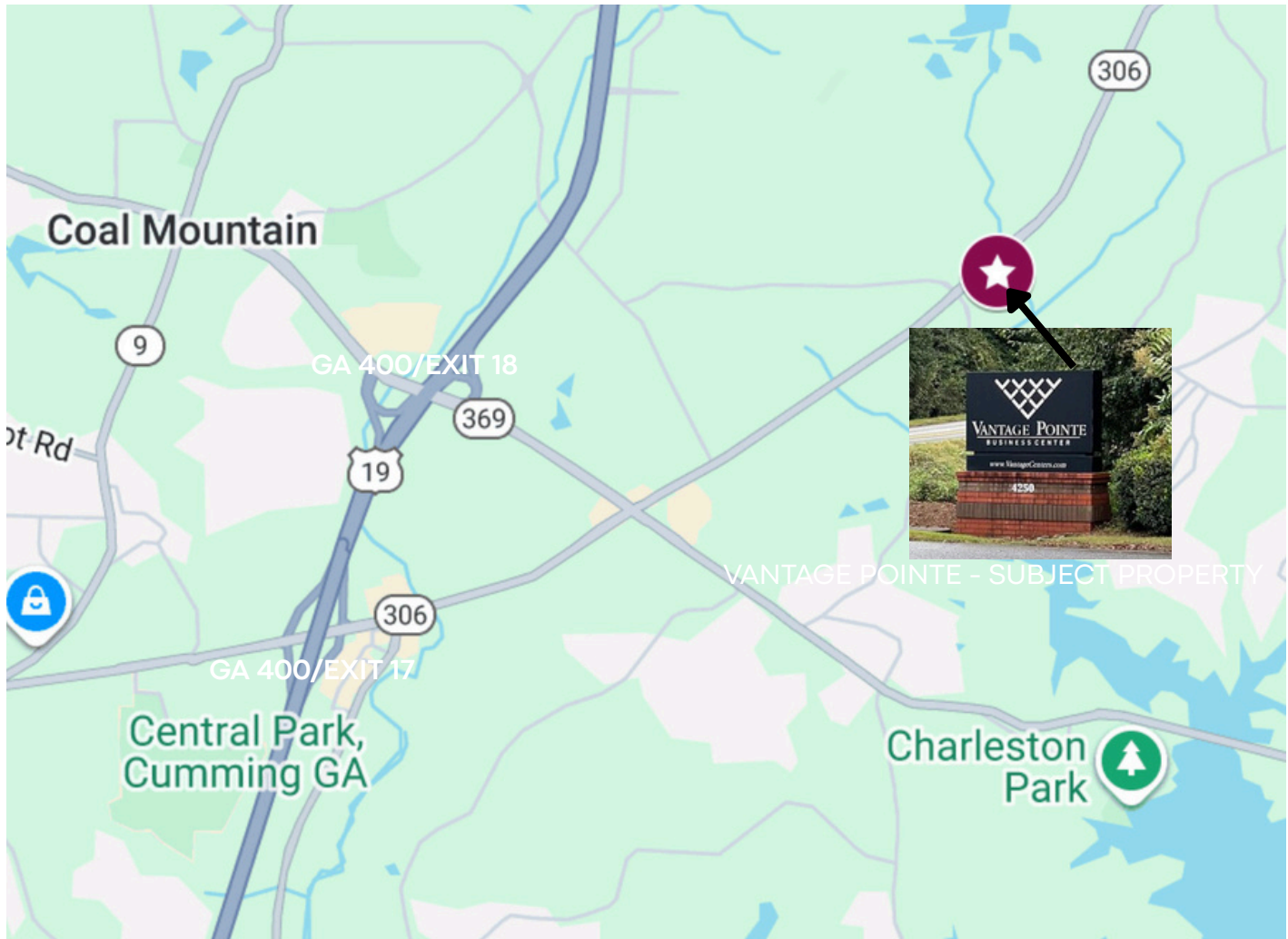

*Disclaimer: The information included in this packet has been obtained from sources believed to be reliable. While Bagley Commercial Properties does not doubt its accuracy, we do not make any guarantee's, warranties, with regards to the included information. It is your responsibility to independently confirm its accuracy and completeness. References to square footage or age are approximate. You and your advisors should conduct a careful, independent investigation of the property to determine to your satisfaction the suitability of the property for your needs. The information contained in this packet is proprietary and confidential, and should not be distributed to any other potential Tenant without the consent of Bagley Commercial Properties.*



## About Bagley Commercial

With over 53 years of combined experience, Bagley Commercial Properties stands among North Georgia's elite real estate firms. The 400 North Board's Circle of Excellence and the title of Best in Forsyth County Commercial Real Estate for six consecutive years. Based in Cumming, the brokerage specializes in industrial, office, retail, land, and commercial transactions. They're known for assembling land parcels for residential and commercial builders, leasing, or selling to national and local clients alike.

Bagley Commercial prides itself on a foundation of integrity, transparency, and exceptional service—now backed by a proven track record and deep local market knowledge.



### Doug Sills

Commercial Sales & Leasing Specialist | Associate Broker

Doug Sills, commercial real estate is about more than buildings and numbers—it's about people, vision, and creating opportunities that last. A Georgia resident for nearly three decades, Doug brings both local expertise and a client-centered approach to every transaction. His background in psychology and professional counseling gives him a unique ability to understand client goals deeply and guide them with clarity and confidence.

Presented by: Doug Sills

 [Doug@BagleyCommercial.com](mailto:Doug@BagleyCommercial.com)

 [770-781-5935 \(office\)](tel:770-781-5935)

 [678-923-5538 \(cell\)](tel:678-923-5538)

 [BagleyCommercial.com](http://BagleyCommercial.com)

Specializing in industrial, retail, investment properties, and land acquisition, Doug helps developers, investors, and business owners make smart, strategic decisions. Whether assembling parcels for a new project, matching landlords with long-term tenants, or guiding investors to high-yield opportunities, he combines data-driven insight with a personal commitment to his clients' success.

 [info@bagleycommercial.com](mailto:info@bagleycommercial.com)

 [www.BagleyCommercial.com](http://www.BagleyCommercial.com)

**Disclaimer:** The information included in this packet has been obtained from sources believed to be reliable. While Bagley Commercial Properties does not doubt its accuracy, we do not make any guarantees or warranties with regard to the included information. It is your responsibility to independently confirm its accuracy and completeness. References to square footage or age are approximate. You and your advisors should conduct a careful, independent investigation of the property to determine to your satisfaction the suitability of the property for your needs. The information contained in this packet is proprietary and confidential, and should not be distributed to any other potential Tenant without the consent of Bagley Commercial Properties.